

Jack series JH-P

Load capacity up to 50 metric tons

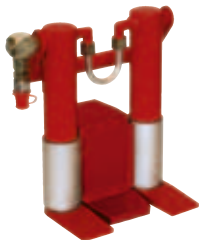

JH 13 P



JH 30 P



JH 50 P

Sketch

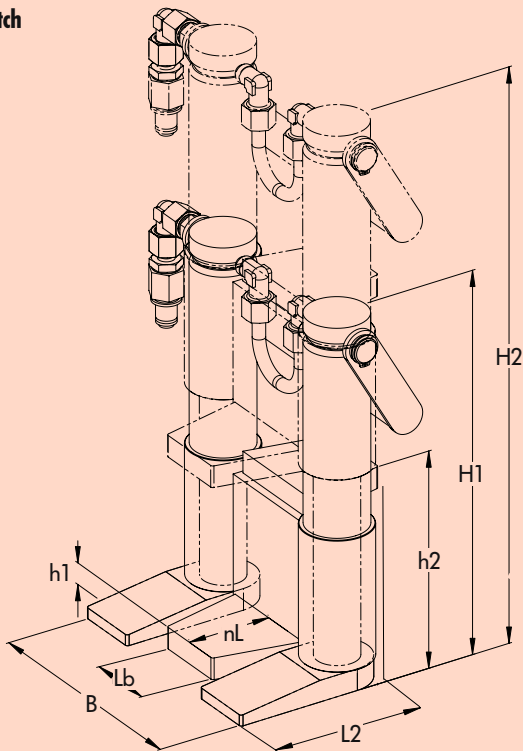

Advantages in detail

- High capacity at low weight.
- Swivelling feet for perfect positioning.
- Even balancing of load and ideal weight distribution through integrated twin cylinder system.
- Convenient push back / transport cart will transport and retract jack effortlessly JRS 1 (included in JSET 30/50).



Application with „Primus“ and central pump

▶ Please refer to page 10 for hand pumps and hydraulic hoses, for electrical pumps to page 11.

Type	Sketch		JH 13 P**	JH 30 P**	JH 50 P**
Full load capacity*		kg / lbs	13 000 / 28 000	30 000 / 66 000	50 000 / 110 000
Stroke		mm / in	160 / 6.2"	200 / 7.8"	250 / 9.8"
Minimum lift height (deep toe)	h 1	mm / in	18 / 0.7"	25 / 1.0"	35 / 1.4"
Minimum lift height (high toe)	h 2	mm / in	135 / 5.3"	185 / 7.3"	275 / 10.8"
Top plate height	H 1	mm / in	303 / 11.9"	455 / 17.8"	542 / 21.2"
Maximum top plate height	H 2	mm / in	463 / 18.2"	655 / 25.8"	792 / 31.6"
Toe width front	L b	mm / in	60 / 2.4"	105 / 4.1"	100 / 3.9"
Useable toe depth	n L	mm / in	50 / 2.0"	70 / 2.8"	85 / 3.3"
Length toe supported	L 2	mm / in	170 / 6.7"	255 / 10.0"	350 / 13.8"
Width	B	mm / in	210 / 8.3"	305 / 11.9"	380 / 14.9"
Cylinder volume		L / in ³	0,4 / 24.41"	1,13 / 68.96"	2,51 / 153.29"
Weight		kg / lbs	15 / 33	51 / 112.4	105 / 231.5
Order number			01 020 130-P	01 020 300-P	01 020 500-P

*On top plate **Eur. patent-no. 1325882