

HIGH-TEMP BAKERY CASTERS

- Excellent Wheels for Bakery Racks
- Soft Tread Wheels Protect Your Floors
- Economical
- Handles the Heat
- Rolls quietly
- Temperature Range: -40° to 485°F intermittent (285°F continuous use)
- Typical applications include: Bakeries, Food Service, Pharmaceutical, Laboratories, Hospitals

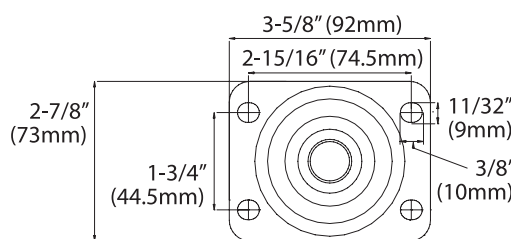

Cross Section

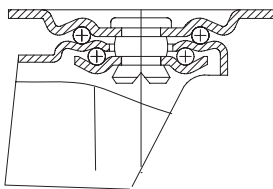

Swivel

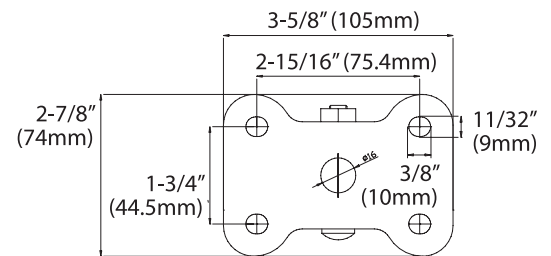

Rigid

HIGH-TEMP BAKERY CASTER SPECIFICATIONS

Diameter (in.)	Tread Width (in.)	Capacity (lbs.)	OAH (in.)	Swivel Lead (in.)	Part Number
ELASTIC RUBBER / ALUMINUM CORE (ER/AL)					
4	1-9/16	170	5-1/8	1-3/8	HTBC-ER/AL-P-0412-S
4	1-9/16	170	5-1/8	N/A	HTBC-ER/AL-P-0412-R
ELASTIC RUBBER / HIGH-TEMP PHENOLIC (ER/TM)					
4	1-3/16	185	5-1/8	1-3/8	HTBC-ER/TM-PL-0411-S
4	1-3/16	185	5-1/8	N/A	HTBC-ER/TM-PL-0411-R
ELASTIC RUBBER / ALUMINUM CORE (ER/AL)					
4	1-9/16	170	1.77	.320	ER/AL-P-0412805
Durometer: 73 Shore A Temperature Range: -40° to 485°F intermittent (285°F continuous use) Bearing: Precision ball. Stainless steel bearings available.					
ELASTIC RUBBER / HIGH-TEMP PHENOLIC (ER/TM)					
4	1-3/16	185	1.77	.412	ER/TM-0404105
Durometer: 85 Shore A Temperature Range: -40° to 485°F intermittent (285°F continuous use) Bearing: Plain bearing. Comes with spanner for 5/16" axles.					